

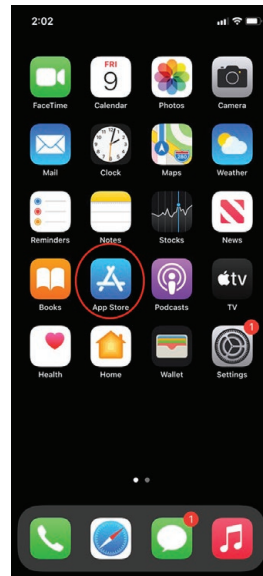

# BSP Wi-Fi Module Setup Instructions for IOS Devices

## 1 Open the "App Store" in your IOS Device:



## 2 Search for "ComCare"

In your App Store, click the search button on the bottom right corner and type "comcare" in the search box, and press "Search" button.

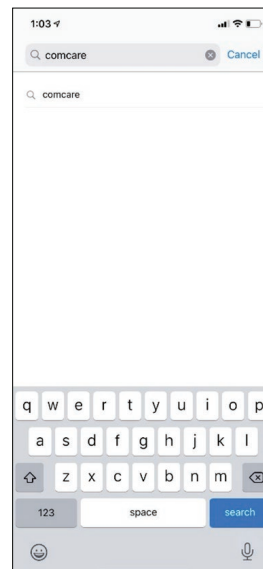

**3** Click the “GET” button to download & install the ComCare App.



**4** When you have successfully installed the ComCare app, it will appear in your device.

Please do NOT open the App at this stage.

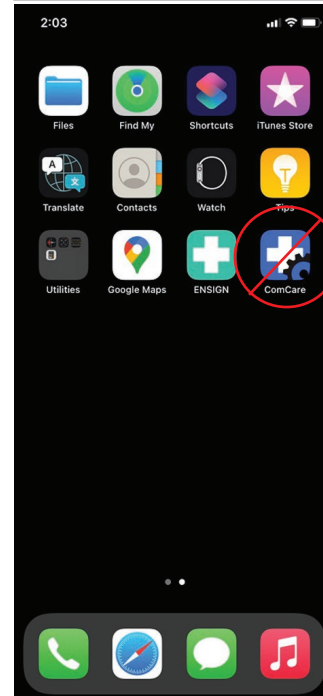

**5** Open “Settings” in your IOS device.

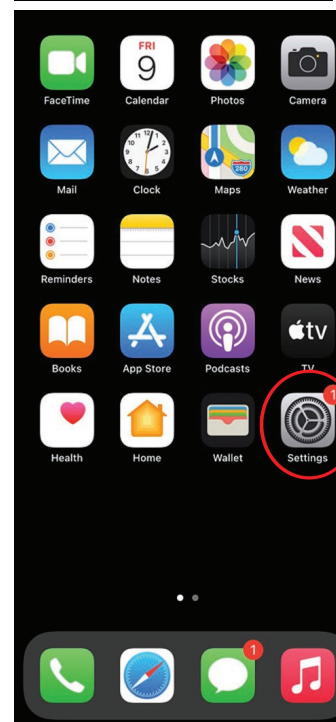

**6 Click the “Wi-Fi” button.**



**7 Select and Connect to HI-LINK\_XXXX**

(XXXX is your Wi-Fi Module ID)

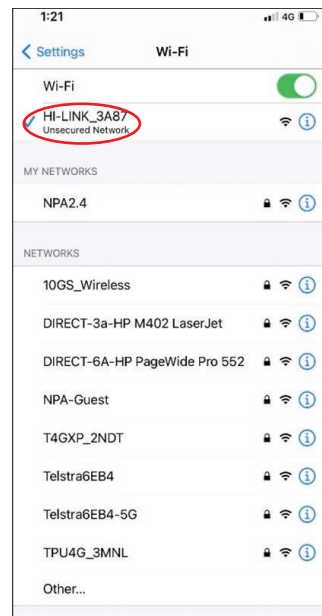

**8 After your device is connected to HI-LINK\_XXXX go back to your home screen and click the ComCare icon to open the ComCare App.**

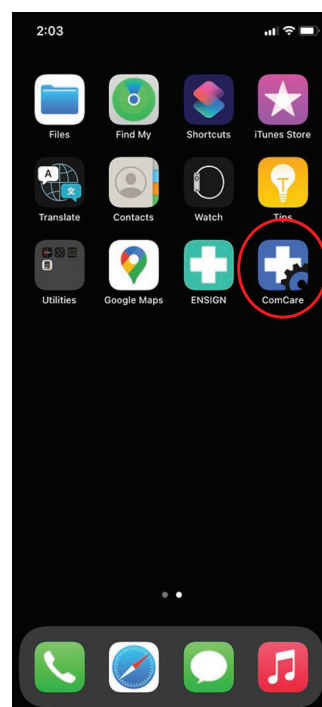

## 9 Configure the BSP's Wi-Fi Module Network Settings

Once the App is open

- Ensure **Connection Type** is selected as **Wireless**
- Change the **Wi-Fi Network Name(SSID)** to **your Wi-Fi network SSID**
- Change **Wi-Fi Password** to **your Wi-Fi password**
- Change **Destination IP** to **www.ensigncloud.com**
- Ensure **Encryption** is **WPA/WPA2-AES**
- Ensure **Port Number** is **5858**
- Then click **Save**



## 10 Connect Your BSP/s to ComCare

Click **OK** to allow ComCare to connect to BSP/s in the local network, then click the **Save** button, and wait for the connection to establish.

Once the connection process is finished, your device will display: **'Setting saved, rebooting'**.

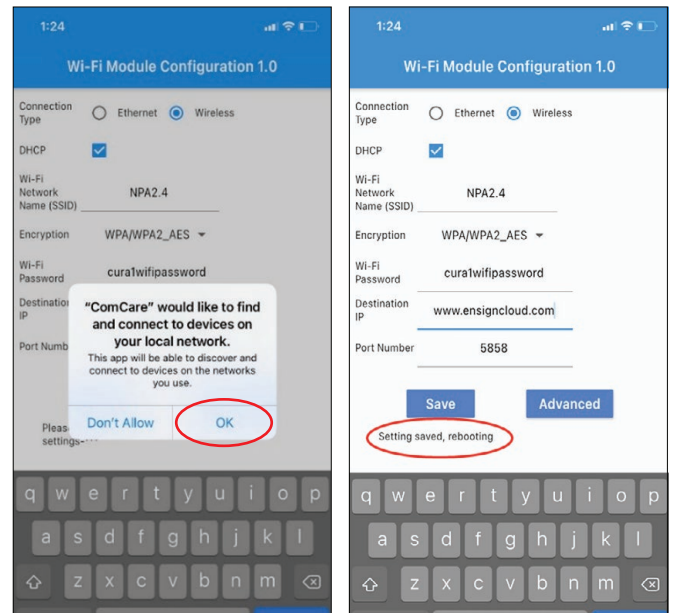

## 11 Check That Your BSP/s Are Visible at www.ensigncloud.com

Your BSP/s should now be visible with your usual web browser at [www.ensigncloud.com](http://www.ensigncloud.com) after you have logged in.

